

To: All Members of the LICENSING SUB-COMMITTEE A
(Other Members for Information)

When calling please ask for:

Kimberly Soane, Democratic Services
Officer

Policy and Governance

E-mail: Kimberly.soane@waverley.gov.uk

Direct line: 01483 523258

Calls may be recorded for training or monitoring

Date: 20 August 2021

Membership of the Licensing Sub-Committee A

Cllr Jerome Davidson
Cllr Patricia Ellis

Cllr Michaela Martin

Dear Councillors

A meeting of the LICENSING SUB-COMMITTEE A will be held as follows:

DATE: THURSDAY, 2 SEPTEMBER 2021

TIME: 10.00 AM

PLACE: COUNCIL CHAMBER, COUNCIL OFFICES, THE BURYS,
GODALMING

The Agenda for the meeting is set out below.

Yours sincerely

ROBIN TAYLOR

Head of Policy and Governance

Most of our publications can be provided in alternative formats. For an audio version, large print, text only or a translated copy of this publication, please contact committees@waverley.gov.uk or call 01483 523351

NOTE FOR MEMBERS

Members are reminded that contact officers are shown at the end of each report and members are welcome to raise questions etc in advance of the meeting with the appropriate officer.

AGENDA

1. ELECTION OF CHAIRMAN

Committee to agree a Chairman for the purposes of this meeting.

2. DISCLOSURE OF INTERESTS

To receive from Members declarations of personal and prejudicial interests in relation to any items included on the agenda for this meeting, in accordance with the Waverley Code of Local Government Conduct.

3. LICENSING ACT 2003 - APPLICATION FOR A NEW PREMISES LICENCE- HAMILTON'S TEA HOUSE, 17 DOWNING STREET, FARNHAM,SURREY GU9 7PB. (Pages 5 - 28)

Purpose and summary

The purpose of the report is to enable the Sub-Committee to consider an application for a new Premises Licence for Hamilton's Tea House, 17 Downing Street, Farnham, Surrey GU9 7PB under section 17 of the Licensing Act 2003. One relevant representation has been received from 'other persons'.

Recommendation

- It is recommended that the Sub-Committee considers the application and evidence of all parties involved at the hearing and then determine the application.
- Members must determine the application in accordance with the Licensing Act 2003 (Hearings) Regulations 2005.
- The Sub-Committee should take such steps as it considers appropriate for the promotion of the licensing objectives.

Once determined, the licensing authority must provide notification of the decision including its reasons to the applicant, any person who has made relevant representations and the Chief Officer of Police for the area in which the premises is situated.

4. LEGAL ADVICE

To consider any legal advice relating to any applications in the agenda.

**For further information or assistance, please telephone
Kimberly Soane, Democratic Services Officer, on 01483 523258 or by
email at Kimberly.soane@waverley.gov.uk**

Waverley Borough Council

LICENSING SUB-COMMITTEE A

2ND SEPTEMBER 2021

Title:

**LICENSING ACT 2003 - APPLICATION FOR A NEW PREMISES LICENCE-
HAMILTON'S TEA HOUSE, 17 DOWNING STREET, FARNHAM,
SURREY GU9 7PB.**

[Wards Affected: All Farnham Wards]

Portfolio Holder: Cllr Palmer, Portfolio Holder for Operational & Enforcement

Head of Service: Richard Homewood Head of Environmental and Regulatory Services

Key decision: No

Access: Public

1. Purpose and summary

- 1.1 The purpose of the report is to enable the Sub-Committee to consider an application for a new Premises Licence for Hamilton's Tea House, 17 Downing Street, Farnham, Surrey GU9 7PB under section 17 of the Licensing Act 2003. One relevant representation has been received from 'other persons'.

2. Background

- 2.1. An application has been received for a new premises licence from Stephen William Hamilton of Hamilton's Tea House Ltd., in respect of a tearoom with approximately 20 covers for food, drink and alcohol over one ground floor in Farnham.
- 2.2 The application proposes that the licence will allow the premises to sell alcohol for consumption both on and off the premises.
- 2.4 In accordance with the legislation, the applicant has sent copies of the application to responsible authorities and was advertised in accordance with the requirements of the Licensing Act 2003. The expiry date for making representations was 10 August 2021.

3. Activities sought under this licence application

3.1 In brief, the applicant seeks to licence the premises for the sale or supply of alcohol as shown below (both on and off sales). An extract of the relevant pages from the new application form is attached at Annexe 1. .

- **Sale of Alcohol (Consumption Off the Premises Only)**

Monday to Sunday 0900 to 2300

- **Opening hours**

Monday to Sunday 0900 to 2300

3.2 Attached at Annexe 2 is a copy of the plans of the premises.

3.3 Attached at Annexe 3 is a plan showing the area of the premises and surrounding properties

4. Representations received

4.1. Within the consultation period, one valid 'relevant representations' was received.

5. Responsible Authorities

5.1 There have been no representation(s) received from Responsible Authorities.

6. Other Persons

6.1 There has been one (1) relevant representation from "other persons". A copy of the representation is attached at Annexe 4.

7. Recommendation

- It is recommended that the Sub-Committee considers the application and evidence of all parties involved at the hearing and then determine the application.
- Members must determine the application in accordance with the Licensing Act 2003 (Hearings) Regulations 2005.
- The Sub-Committee should take such steps (as described at paragraph 8.11

below) as it considers appropriate for the promotion of the licensing objectives.

Once determined, the licensing authority must provide notification of the decision including its reasons to the applicant, any person who has made relevant representations and the Chief Officer of Police for the area in which the premises is situated.

8. Reason for the recommendation

- 8.1 The general principle is that an application for a new Premises Licence must be granted unless relevant representations are received. This is subject to the proviso that the applicant has complied with regulations in advertising and submitting the application.
- 8.2 Relevant representations are those which:
- Are about the effect of the granting of the application on the promotion of the licensing objectives
 - Are made by a Responsible Authority or other persons
 - Have not been withdrawn
 - Are not, in the opinion of the relevant Licensing Authority, frivolous or vexatious.
- 8.3 Licensing authorities are required to carry out licensing functions under the Licensing Act 2003 with a view to promoting the four licensing objectives of:-
- Prevention of crime and disorder;
 - Public safety;
 - Prevention of nuisance; and
 - Protection of children from harm.
- 8.4 Members should note that each objective is of equal importance. There are no other licensing objectives, and the four objectives are paramount considerations at all times.
- 8.5 The Licensing Sub-Committee must also consider Waverley Borough Council's Statement of Licensing Policy when deciding whether or not to grant the application. The terms of the Statement of Licensing Policy are highly persuasive, but not binding, on the Licensing Sub-Committee. The Licensing Sub-Committee may depart from the guidance contained in the Statement of Licensing Policy if it considers there are clear and convincing reasons to do so.
- 8.6 Where there is a conflict between the Licensing Act 2003 and the Statement of Licensing Policy, the Licensing Act 2003 must prevail.
- 8.7 Members are required to have regard to the Home Office Guidance issued under section 182 of the Licensing Act 2003 in carrying out the functions of licensing authority. However, guidance does not cover every possible situation, so long as

the guidance has been properly and carefully understood, members may depart from it if they have reason to do so. Full reasons must be given if this is the case

8.8 The guidance will be available for reference purposes at the meeting.* Particular attention is drawn to:

- Conditions – paragraphs 1.16-1.17 and 10.1 to 10.66
- The Licensing Objectives – paragraphs 2.1–2.32
- Hearings - paragraphs 9.31 to 9.44

The guidance can be found at:

https://assets.publishing.service.gov.uk/government/uploads/system/uploads/attachment_data/file/705588/Revised_guidance_issued_under_section_182_of_the_Licensing_Act_2003_April_2018_.pdf

8.9 When relevant representations are received then the Sub-Committee must have regard to them.

8.10 The Licensing Sub-Committee can attach a “weight” to any relevant representations, such factors that could influence the “weight” to be placed on a representation could include:

- Whether the representation can be clearly related to any one of the four licensing objectives;
- Whether the representation concerns matters over which the applicant is able to exercise control;
- Whether the representation is based on “hearsay” evidence;
- Whether the representation is supported by firm evidence;
- Whether the person making the representation has attended the hearing in person.

8.11 The Sub-Committee must consider the application on its individual merits and take into account all relevant matters, then determine the application by taking the steps it considers appropriate and necessary / proportionate to promote the licensing objectives. Having considered all relevant representations, and having taken into account the promotion of the licensing objectives, a decision can be taken:

- To grant the licence, subject to the mandatory conditions and conditions consistent with the operating schedule;
- To impose additional relevant conditions to such an extent as is considered necessary for the promotion of the licensing objectives;
- To exclude any of the licensable activities to which the application relates
- To amend the times for all or some of the licensable activities;
- To refuse to specify a person on the licence as the designated premises supervisor
- To reject the application

9. Conditions

9.1 Conditions will not be necessary if they duplicate a current statutory requirement and there is no duty to impose conditions consistent with the operating schedule – rather it is a power.

Conditions must relate to the representation(s) and any conditions imposed must be proportionate, clear, achievable and enforceable. Evident is required before conditions, restrictions or refusals can be imposed following representations – speculation is not sufficient but this does not prevent conditions being attached to a new premises on the basis of the history of the premises or the applicant (Daniel Thwaites PLC v Wirral Borough Magistrates' Court [2008] EWHC 838 Admin).

9.2 Members are also referred to the Home Office guidance on conditions, specifically section 10 (para 10.10) which states that licensing conditions should be tailored to the size, type, location and characteristics and activities taking place at the premises. Conditions should be determined on a case-by-case basis and standardised conditions, which ignore these individual aspects, should be avoided. Licensing authorities and other responsible authorities should be alive to the indirect costs that can arise because of conditions.

9.3 Licensing authorities should therefore ensure that any conditions they impose, are only those which are appropriate for the promotion of the licensing objectives.

9.4 If the Sub-Committee determines that it is necessary to modify the conditions, or to refuse the application for a Premises Licence application, it must give reasons for its decision.

10. The Role of the Licensing Sub-Committee

10.1 Members should note that the Licensing Sub-Committee is meeting on this occasion solely to perform the role of licensing authority. The Sub-Committee sits in quasi-judicial capacity and must act impartially. It must offer a fair and unbiased hearing of the application. In this case, Members should disregard the Council's broader policy objectives and role as statutory authority in other contexts. Members must direct themselves to making a determination solely based upon the Licensing Law, Guidance and the Council's Statement of Licensing Policy.

10.2 As a quasi-judicial body the Licensing Sub-Committee is required to consider the application on its merits. The Sub-Committee must take into account only relevant factors and ignore irrelevant factors. The decision must be based on material evidence, which tends logically to show the existence or non-existence of relevant facts, the occurrence of which would be relevant.

10.3 The Licensing Sub-Committee must give fair consideration to the contentions of all persons entitled to make representations to them.

10.4 The Licensing Sub-Committee is entitled to consider events outside of the premises if they are relevant, i.e., are properly attributable to the premises being open. The proprietors do not have to be personally responsible for the incidents for the same to

be relevant. However, if such events are not properly attributable to the premises being open, then the evidence is not relevant and should be excluded. Guidance is that the licensing authority will primarily focus on the direct impact of the activities taking place at the licensed premises on members of the public, living, working, or engaged in normal activity in the area concerned.

10.5 The Sub-Committee can only consider matters within the application that have been raised through representations from Responsible Authorities (none in this case) and other persons. This will be decided on a case-to-case basis.

11. Relationship to the Corporate Strategy and Service Plan

11.1 Waverley promotes and sustains a thriving local economy.

12. Implications of decision

12.1 Resource (Finance, procurement, staffing, IT)

Members should be aware that Environmental and Regulatory Services does not have a direct budget provision for costs, should the applicant be successful in appealing to the Magistrates Court against a decision of the Council.

12.2 Risk management

Not applicable

12.3 Legal

An appeal against the determination of this application may be made to the Magistrates' Court within 21 days of all parties being notified of the local authority's decision. The applicant or any party making representation may make an appeal.

12.4 Equality, diversity, and inclusion

Under the Human Rights Act 1998, the Sub-Committee needs to consider the balance between the rights of the licensee and those making representations when making their decision. The Sub-Committee has a duty under section 17 of the Crime and Disorder Act 1998 when making its decision to do all it can to prevent crime and disorder in the Waverley area.

12.5 Climate emergency declaration

There are no matters which directly impact upon the climate emergency declaration.

13. Consultation and engagement

13.1 The application has been advertised at the premises and in a local paper in accordance with the requirements of the Licensing Act 2003

14. Other options considered

14.1 Not applicable

15. Governance journey

15.1 Not applicable

Annexes:

Annexe 1 – An extract of the relevant pages from the new application form

Annexe 2 – A copy of the plans of the premises

Annexe 3 – A plan showing the area of the premises and surrounding properties

Annexe 4 – Copy of the representation received from ‘Other Persons’

Background Papers

Background papers, as defined by Section 100D(5) of the Local Government Act 1972) are

The Licensing Act 2003

Guidance under 182 Licensing Act 2003

Waverley’s Statement of Licensing Policy

.

CONTACT OFFICER:

Name: Paul Hughes

Position: Licensing & Environmental Enforcement Manager

Telephone: 0148 3523189

Email: paul.hughes@waverley.gov.uk

Agreed and signed off by

Legal Services: date

Head of Finance: date

Strategic Director: date

Portfolio Holder: date

This page is intentionally left blank



Application for a premises licence to be granted under the Licensing Act 2003

PLEASE READ THE FOLLOWING INSTRUCTIONS FIRST

Before completing this form please read the guidance notes at the end of the form. If you are completing this form by hand please write legibly in block capitals. In all cases ensure that your answers are inside the boxes and written in black ink. Use additional sheets if necessary.

You may wish to keep a copy of the completed form for your records.

I/We STEPHEN WILLIAM HAMILTON
(Insert name(s) of applicant)

apply for a premises licence under section 17 of the Licensing Act 2003 for the premises described in Part 1 below (the premises) and I/we are making this application to you as the relevant licensing authority in accordance with section 12 of the Licensing Act 2003

Part 1 - Premises details

Postal address of premises or, if none, ordnance survey map reference or description
HAMILTON'S TEA HOUSE
17 DOWNING STREET
Post town FARNHAM Postcode GU9 7PB

Telephone number at premises (if any)
Non-domestic rateable value of premises £19,500.00

Part 2 - Applicant details

Please state whether you are applying for a premises licence as appropriate Please tick as

- a) an individual or individuals * [] please complete section (A)
b) a person other than an individual *
i as a limited company/limited liability partnership [x] please complete section (B)
ii as a partnership (other than limited liability) [] please complete section (B)
iii as an unincorporated association or [] please complete section (B)

- iv other (for example a statutory corporation) please complete section (B)
- c) a recognised club please complete section (B)
- d) a charity please complete section (B)
- e) the proprietor of an educational establishment please complete section (B)
- f) a health service body please complete section (B)
- g) a person who is registered under Part 2 of the Care Standards Act 2000 (c14) in respect of an independent hospital in Wales please complete section (B)
- ga) a person who is registered under Chapter 2 of Part 1 of the Health and Social Care Act 2008 (within the meaning of that Part) in an independent hospital in England please complete section (B)
- h) the chief officer of police of a police force in England and Wales please complete section (B)

* If you are applying as a person described in (a) or (b) please confirm (by ticking yes to one box below):

- I am carrying on or proposing to carry on a business which involves the use of the premises for licensable activities; or
- I am making the application pursuant to a statutory function or
- a function discharged by virtue of Her Majesty's prerogative

(A) INDIVIDUAL APPLICANTS (fill in as applicable)

Mr <input type="checkbox"/>	Mrs <input type="checkbox"/>	Miss <input type="checkbox"/>	Ms <input type="checkbox"/>	Other Title (for example, Rev)	
Surname			First names		
Date of birth over		I am 18 years old or		<input type="checkbox"/>	Please tick yes
Nationality					
Current residential address if different from premises address					
Post town				Postcode	
Daytime contact telephone number					
E-mail address (optional)					

SECOND INDIVIDUAL APPLICANT (if applicable)

Mr <input type="checkbox"/>	Mrs <input type="checkbox"/>	Miss <input type="checkbox"/>	Ms <input type="checkbox"/>	Other Title (for example, Rev)	
Surname			First names		
Date of birth over		I am 18 years old or		<input type="checkbox"/>	Please tick yes
Nationality					
Current postal address if different from premises address					
Post town		Postcode			
Daytime contact telephone number					
E-mail address (optional)					

(B) OTHER APPLICANTS

Please provide name and registered address of applicant in full. Where appropriate please give any registered number. In the case of a partnership or other joint venture (other than a body corporate), please give the name and address of each party concerned.

Name	HAMILTON'S TEA HOUSE LTD
Address	2 BAKER OATS DRIVE FARNHAM SURREY GU10 4DT
Registered number (where applicable)	1330 8100
Description of applicant (for example, partnership, company, unincorporated association etc.)	LIMITED COMPANY
Telephone number (if any)	
E-mail address (optional)	

Part 3 Operating Schedule

When do you want the premises licence to start?

DD	MM	YYYY
1	4	08 2021

If you wish the licence to be valid only for a limited period, when do you want it to end?

DD	MM	YYYY

Please give a general description of the premises (please read guidance note 1)

A SINGLE STOREY RETAIL SPACE IN THE CENTRE OF FARNHAM. THE BUILDING WILL INCLUDE A SMALL FOOD PREPARATION AREA, CUSTOMER TOILETS AND APPROX. 20 COVERS. FOOD, DRINK + ALCOHOL PROVIDED WILL BE CONSUMED IN BOTH THIS BUILDING (A-ON THE PLAN) AND IN THE OPEN-AIR COURTYARD (B-ON THE PLAN).

If 5,000 or more people are expected to attend the premises at any one time, please state the number expected to attend.

/

What licensable activities do you intend to carry on from the premises?

(please see sections 1 and 14 and Schedules 1 and 2 to the Licensing Act 2003)

Provision of regulated entertainment (please read guidance note 2)

Please tick all that apply

- a) plays (if ticking yes, fill in box A)
- b) films (if ticking yes, fill in box B)
- c) indoor sporting events (if ticking yes, fill in box C)
- d) boxing or wrestling entertainment (if ticking yes, fill in box D)
- e) live music (if ticking yes, fill in box E)
- f) recorded music (if ticking yes, fill in box F)
- g) performances of dance (if ticking yes, fill in box G)
- h) anything of a similar description to that falling within (e), (f) or (g) (if ticking yes, fill in box H)

Provision of late night refreshment (if ticking yes, fill in box I)

Supply of alcohol (if ticking yes, fill in box J)

In all cases complete boxes K, L and M

Supply of alcohol Standard days and timings (please read guidance note 7)			Will the supply of alcohol be for consumption – please tick (please read guidance note 8)	On the premises	<input type="checkbox"/>			
				Off the premises	<input type="checkbox"/>			
				Both	<input checked="" type="checkbox"/>			
Day	Start	Finish	State any seasonal variations for the supply of alcohol (please read guidance note 5)					
Mon	09:00	23:00						
Tue	09:00	23:00						
Wed	09:00	23:00						
Thur	09:00	23:00				Non standard timings. Where you intend to use the premises for the supply of alcohol at different times to those listed in the column on the left, please list (please read guidance note 6)		
Fri	09:00	23:00						
Sat	09:00	23:00						
Sun	09:00	23:00						

State the name and details of the individual whom you wish to specify on the licence as designated premises supervisor (Please see declaration about the entitlement to work in the checklist at the end of the form):

Name	STEPHEN WILLIAM HAMILTON	
Date of birth		
Address		
Postcode		
Personal licence number (if known)	STOKE OT	
Issuing licensing authority (if known)	STOKE-ON-TRENT	

K

Please highlight any adult entertainment or services, activities, other entertainment or matters ancillary to the use of the premises that may give rise to concern in respect of children (please read guidance note 9).

N/A

L

Hours premises are open to the public Standard days and timings (please read guidance note 7)			State any seasonal variations (please read guidance note 5)
Day	Start	Finish	
Mon	07:00	23:00	
Tue	07:00	23:00	
Wed	07:00	23:00	
Thur	07:00	23:00	
Fri	07:00	23:00	
Sat	07:00	23:00	
Sun	07:00	23:00	

Non standard timings. Where you intend the premises to be open to the public at different times from those listed in the column on the left, please list (please read guidance note 6)

TO BEGIN WITH, IT IS MY INTENTION TO OPEN THE TEA HOUSE BETWEEN 09:00 + 18:00, 7 DAYS A WEEK. WE WILL ONLY REQUIRE THE EXTRA HOURS AND ALCOHOL SUPPLY FOR A NUMBER OF PRIVATE EVENTS AND ADDITIONAL HOURS AS NEEDED FOR THE BUSINESS.

M Describe the steps you intend to take to promote the four licensing objectives:

a) General – all four licensing objectives (b, c, d and e) (please read guidance note 10)

TRAINING OF ALL STAFF WILL TAKE PRIORITY AND WILL BE BOTH COMPREHENSIVE AND ONGOING. WE WILL OPERATE THE 'CHALLENGE 25' POLICY. THE NATURE OF THE BUSINESS AND PRICE POINTS ARE AIMED AT SMALL INTAKES OF ALCOHOL ALONGSIDE FOOD CONSUMPTION.

b) The prevention of crime and disorder

STAFF TRAINING, UNDER PINNED BY ADDITIONAL INFORMATION IN THE STAFF HANDBOOK WILL MEET THIS OBJECTIVE. THE SMALL NUMBER OF COVERS WILL ALLOW OUR STAFF TO KEEP REGULAR CHECKS ON ALL CUSTOMERS AND THEIR BEHAVIOUR.

c) Public safety

FULL RISK ASSESSMENT WILL BE UNDERTAKEN AND ALL STAFF WILL BE FIRST AID TRAINED AND EQUIPPED. THERE WILL ALSO BE H&S TRAINING AS WELL AS ONGOING GOVERNMENT GUIDELINE ASSESSMENTS AND IMPLEMENTATION.

d) The prevention of public nuisance

EXTERNAL SIGNAGE WILL BE USED TO UNDERPIN OUR NEED TO BE 'GOOD NEIGHBOURS' AND ASK CUSTOMERS TO ACT ACCORDINGLY. OUR CORE OFFER IS AIMED AT A SLIGHTLY OLDER CLIENTELE WHO ARE MORE LIKELY TO BE CONSERVATIVE IN THEIR NATURE.

e) The protection of children from harm

WE WILL ONLY ACCEPT PHOTOGRAPHIC APPROVED MEANS OF ID AND SHALL OPERATE THE 'CHALLENGE 25' POLICY, STRICTLY.

Checklist:

Please tick to indicate agreement

- I have made or enclosed payment of the fee.
- I have enclosed the plan of the premises.
- I have sent copies of this application and the plan to responsible authorities and others where applicable.
- I have enclosed the consent form completed by the individual I wish to be designated premises supervisor, if applicable.
- I understand that I must now advertise my application.
- I understand that if I do not comply with the above requirements my application will be rejected.
- [Applicable to all individual applicants, including those in a partnership which is not a limited liability partnership, but not companies or limited liability partnerships] I have included documents demonstrating my entitlement to work in the United Kingdom (please read note 15).

IT IS AN OFFENCE, UNDER SECTION 158 OF THE LICENSING ACT 2003, TO MAKE A FALSE STATEMENT IN OR IN CONNECTION WITH THIS APPLICATION. THOSE WHO MAKE A FALSE STATEMENT MAY BE LIABLE ON SUMMARY CONVICTION TO A FINE OF ANY AMOUNT.

IT IS AN OFFENCE UNDER SECTION 24B OF THE IMMIGRATION ACT 1971 FOR A PERSON TO WORK WHEN THEY KNOW, OR HAVE REASONABLE CAUSE TO BELIEVE, THAT THEY ARE DISQUALIFIED FROM DOING SO BY REASON OF THEIR IMMIGRATION STATUS. THOSE WHO EMPLOY AN ADULT WITHOUT LEAVE OR WHO IS SUBJECT TO CONDITIONS AS TO EMPLOYMENT WILL BE LIABLE TO A CIVIL PENALTY UNDER SECTION 15 OF THE IMMIGRATION, ASYLUM AND NATIONALITY ACT 2006 AND PURSUANT TO SECTION 21 OF THE SAME ACT, WILL BE COMMITTING AN OFFENCE WHERE THEY DO SO IN THE KNOWLEDGE, OR WITH REASONABLE CAUSE TO BELIEVE, THAT THE EMPLOYEE IS DISQUALIFIED.

Part 4 – Signatures (please read guidance note 11)

Signature of applicant or applicant’s solicitor or other duly authorised agent (see guidance note 12). If signing on behalf of the applicant, please state in what capacity.

Declaration	<ul style="list-style-type: none"> • [Applicable to individual applicants only, including those in a partnership which is not a limited liability partnership] I understand I am not entitled to be issued with a licence if I do not have the entitlement to live and work in the UK (or if I am subject to a condition preventing me from doing work relating to the carrying on of a licensable activity) and that my licence will become invalid if I cease to be entitled to live and work in the UK (please read guidance note 15). • The DPS named in this application form is entitled to work in the UK (and is not subject to conditions preventing him or her from doing work relating to a licensable activity) and I have seen a copy of his or her proof of entitlement to work, if appropriate (please see note 15)
Signature	
Date	12.07.2021

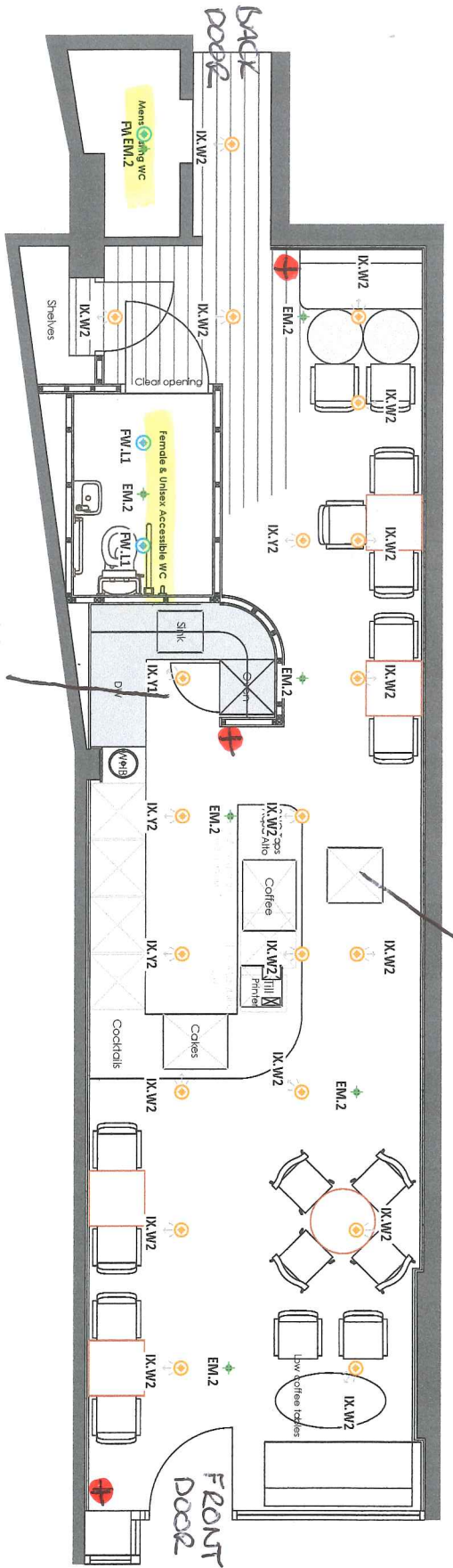

+ = FIRE EXTINGUISHERS (X3) CIA

KITCHEN SPACE

DOES NOT EXIST - MISTAKE ON RANDI!

Legend

Recessed	
Quantity: 1 Item: IX.F2 Symbol:	Name: Krios I Lumen Output: 3700 lm Colour Temp: 2700K Reflector: 25°
Quantity: 15 Item: IX.W2 Symbol:	Name: Krios I Lumen Output: 3700 lm Colour Temp: 2700K Reflector: 57°
Quantity: 1 Item: IX.V1 Symbol:	Name: Krios I HO Lumen Output: 4550 lm Colour Temp: 2700K Reflector: 80°
Quantity: 3 Item: IX.Y2 Symbol:	Name: Krios I Lumen Output: 3700 lm Colour Temp: 2700K Reflector: 80°
Quantity: 3 Item: FW.L1 Symbol:	Name: Alpha Round Fixed Lumen Output: 1250 lm Colour Temp: 3000K Reflector: 45°
Quantity: 7 Item: EM.2 Symbol:	Name: Mini EM Emergency Lumen Output: 200 lm Colour Temp: 6500 K Reflector: EscapeRoute

Total Lighting Fixtures: 30 Pieces

Client	Hamilton's
Store	Hamilton's Tea Room
Location	England
Object	Tea Room
Subject	Lighting Plan
Scale	1:50
Project Code	HIM21-IL-HMTN-PI-V01-R00
Reference Drawings	HAMILTONS.dwg
Stage	Rev.
Date	
Description	
Designer	Cansin D.
Total of	54.43m ²
Height in	2.60 m

Imoon
PROFESSIONAL LIGHTING SOLUTIONS

The information on this page is for reference only. It is not intended to be used as a substitute for professional advice. The information is subject to change without notice. For more information, please contact us at: info@imoon.com or +31 (0) 20 488 8888.

Hamilton s Tea House. 17, Downing Street, Farnham, Surrey, GU9 7PB

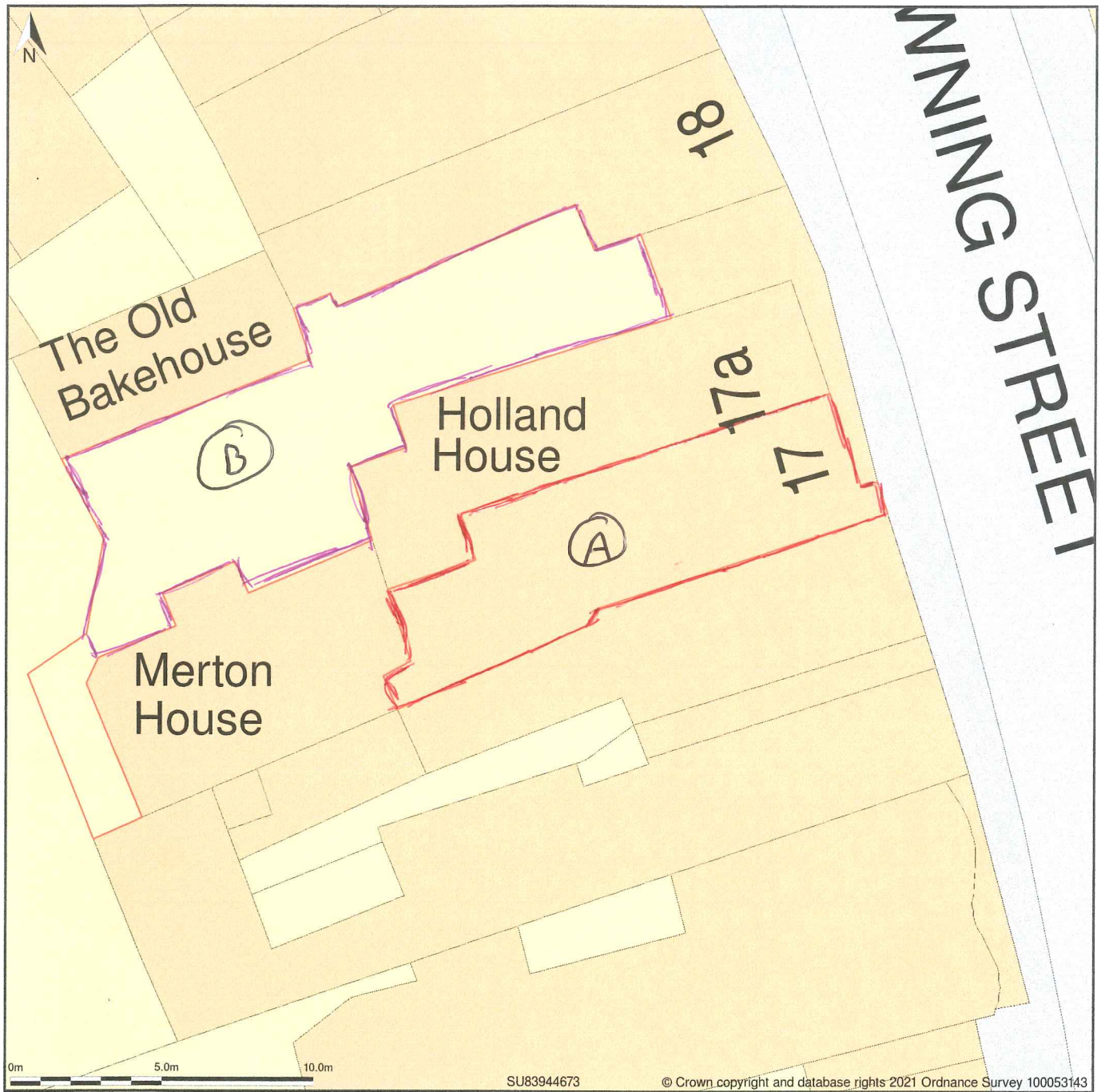

Block Plan shows area bounded by: 483930.0, 146714.98 483966.0, 146750.98 (at a scale of 1:200), OSGridRef: SU83944673. The representation of a road, track or path is no evidence of a right of way. The representation of features as lines is no evidence of a property boundary.

Produced on 16th Jun 2021 from the Ordnance Survey National Geographic Database and incorporating surveyed revision available at this date. Reproduction in whole or part is prohibited without the prior permission of Ordnance Survey. © Crown copyright 2021. Supplied by www.buyaplan.co.uk a licensed Ordnance Survey partner (100053143). Unique plan reference: #00642218-76B328

Ordnance Survey and the OS Symbol are registered trademarks of Ordnance Survey, the national mapping agency of Great Britain. Buy A Plan logo, pdf design and the www.buyaplan.co.uk website are Copyright © Pass Inc Ltd 2021

A - HAMILTON'S TEA HOUSE* - OUTLINED IN RED
 B - OPEN AIR COURTYARD FOR EXTERNAL SEATING - OUTLINED IN BLUE
 * DETAILED PLAN OF THE INTERNAL LAYOUT ATTACHED.

Hamilton s Tea House, 17, Downing Street, Farnham, Surrey, GU9 7PB

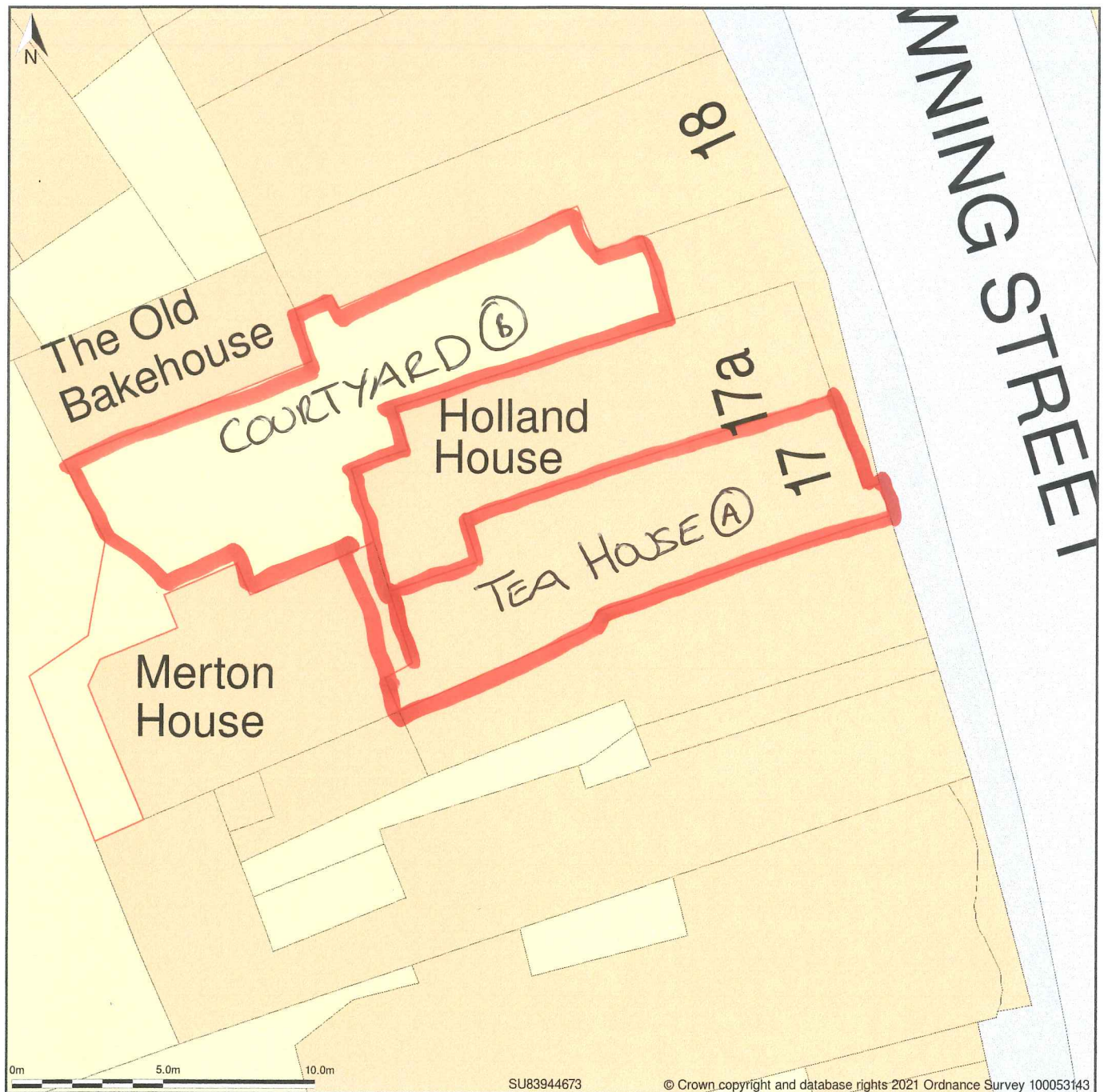

Block Plan shows area bounded by: 483930.0, 146714.98 483966.0, 146750.98 (at a scale of 1:200), OSGridRef: SU83944673. The representation of a road, track or path is no evidence of a right of way. The representation of features as lines is no evidence of a property boundary.

Produced on 7th Jul 2021 from the Ordnance Survey National Geographic Database and incorporating surveyed revision available at this date. Reproduction in whole or part is prohibited without the prior permission of Ordnance Survey. © Crown copyright 2021. Supplied by www.buyaplan.co.uk a licensed Ordnance Survey partner (100053143). Unique plan reference: #00642218-76B328

Ordnance Survey and the OS Symbol are registered trademarks of Ordnance Survey, the national mapping agency of Great Britain. Buy A Plan logo, pdf design and the www.buyaplan.co.uk website are Copyright © Pass Inc Ltd 2021

LICENSABLE ACTIVITIES

This page is intentionally left blank

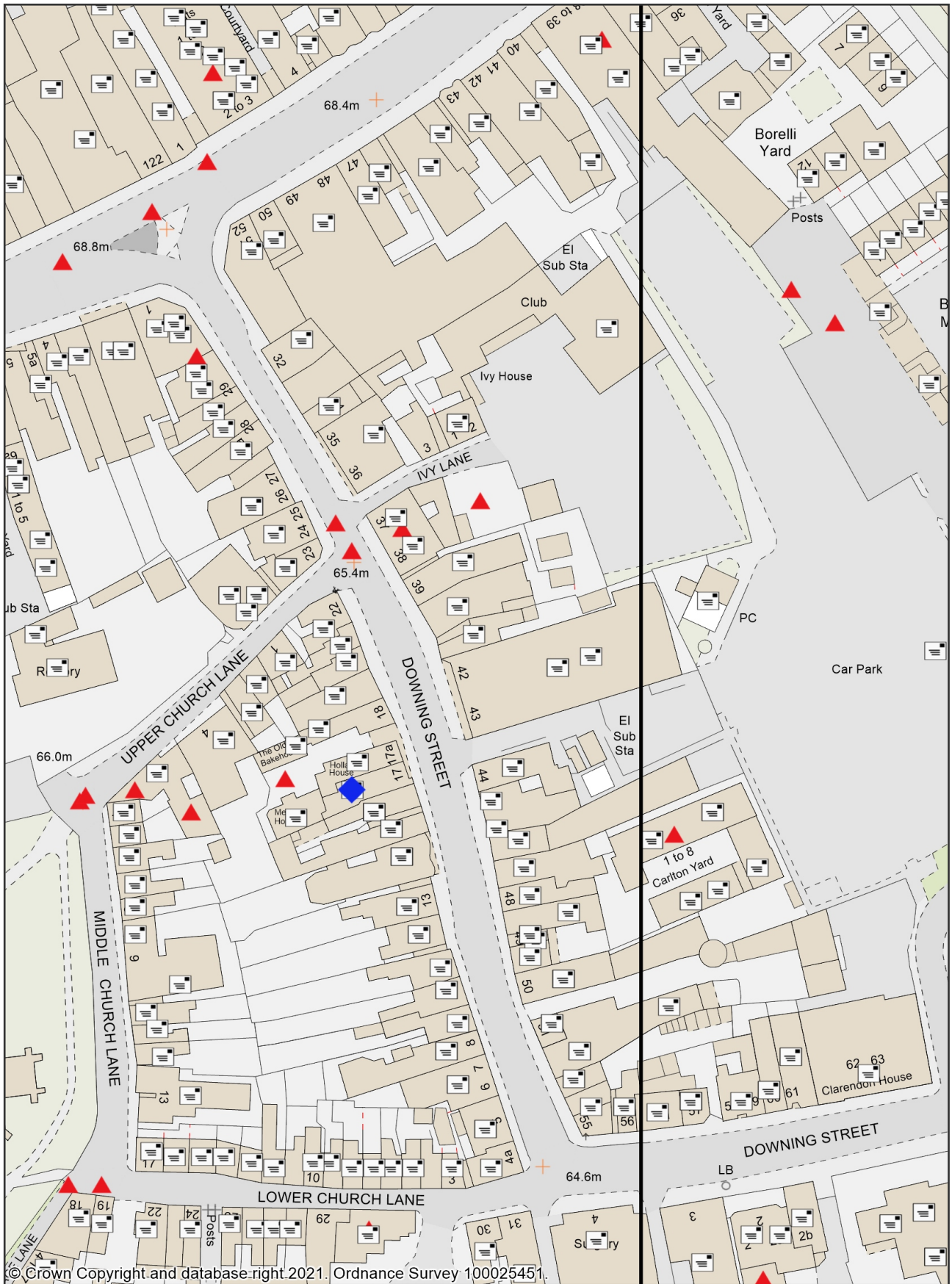

Hamilton's Tea Room

Waverley Borough Council
 The Bury, Godalming
 Surrey, GU7 1HR
 Telephone: 01483 523333
 Fax No: 01483 426337

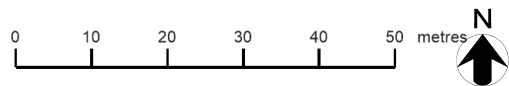

Printed: 18 August 2021 Scale at A4: 1:1000

You are permitted to use this data solely to enable you to respond to, or interact with, the organisation that provided you with the data. You are not permitted to copy, sub-licence, distribute or sell any of this data to third parties in any form.

This page is intentionally left blank

Objection 1

Worksheet (Licensing) - WK/202103245

Address Hamilton's Tea House, 17 Downing Street, Farnham, Surrey, GU9 7PB.

Worksheet | Licensing | Premises | Operating Schedule | Representations | **Hearing** | Further Data | Schedule | Actions

Representations / Consultations

Type **NEIG** **Neighbour** Attend Hearing

Address **Objector.**

Where consultation with an agency:

Date Sent **13/07/2021** Return Target **10/08/2021**

Date Received **20/07/2021** Response **OBJ5** **2 or more licensing objectives**

Notes
I would like to strongly object to the proposed cafe and especially because of the request to have an alcohol licence in the evenings. There are a lot of residents on the street, including myself, some have young children. The licenced time runs until 11 pm but there will then be drinking up time and then drunk people outside, talking loudly, for some time after this e.g. whilst waiting for taxis. Downing Street is often a race track late at night, so there is risk of the safety of Hamilton's customers who will not be expecting fast traffic.

Completed Decision

Officer

This page is intentionally left blank